

CQ

coding positions for CQ 12 connector

Key position (M insert side)	Key position (F insert side)	View (M insert side)	View (M insert side)	View (F insert side)	View (F insert side)
A	B	A	B	B	A
1	1	▼	▼	▲	▲
1	2	▼	▲	▼	▲
1	3	▼	▼	▲	▲
1	4	▼	▲	▼	▲
2	1	▲	▼	▲	▼
2	2	▲	▲	▼	▼
2	3	▲	▼	▲	▼
2	4	▲	▲	▼	▼
3	1	▼	▼	▲	▲
3	2	▼	▲	▼	▲
3	3	▼	▼	▲	▲
3	4	▼	▲	▼	▲
4	1	▲	▼	▲	▼
4	2	▲	▲	▼	▼
4	3	▲	▼	▲	▼
4	4	▲	▲	▼	▼

enclosures:
 size "21.21" page:

insulating type 201 - 202
 metallic type 203 - 205
 aggressive environments 325
 EMC 343
 IP68 372 - 373

inserts, crimp connections



10A crimp contacts
 silver and gold plated



description

part No.

part No. part No.

without contacts (to be ordered separately)
 female inserts for female contacts
 male inserts for male contacts

CQF 12
CQM 12

10A female contacts

0.14-0.37 mm ²	AWG 26-22	identification No. 1
0.5 mm ²	AWG 20	identification No. 2
0.75 mm ²	AWG 18	identification No. ②
1 mm ²	AWG 18	identification No. 3
1.5 mm ²	AWG 16	identification No. 4
2.5 mm ²	AWG 14	identification No. 5

CDFA 0.3
CDFA 0.5
CDFA 0.7
CDFA 1.0
CDFA 1.5
CDFA 2.5

silver plated

CDFD 0.3
CDFD 0.5
CDFD 0.7
CDFD 1.0
CDFD 1.5
CDFD 2.5

gold plated

10A male contacts

0.14-0.37 mm ²	AWG 26-22	identification No. 1
0.5 mm ²	AWG 20	identification No. 2
0.75 mm ²	AWG 18	identification No. ②
1 mm ²	AWG 18	identification No. 3
1.5 mm ²	AWG 16	identification No. 4
2.5 mm ²	AWG 14	identification No. 5

CDMA 0.3
CDMA 0.5
CDMA 0.7
CDMA 1.0
CDMA 1.5
CDMA 2.5

CDMD 0.3
CDMD 0.5
CDMD 0.7
CDMD 1.0
CDMD 1.5
CDMD 2.5

- characteristics according to EN 61984:
10A 400V 6kV 3
10A 400/690V 6kV 2
- cUL (UL for USA and Canada), CCC, GL, GOST certified
- rated voltage according to UL/CSA: 600V
- insulation resistance: ≥ 10 GΩ
- ambient temperature limit: -40 °C ... +125 °C
- are made of self-extinguishing thermoplastic resin UL 94 V0
- mechanical life: ≥ 500 cycles
- contact resistance: ≤ 3 mΩ
- the CQ 12 inserts are already supplied with a seal and a screw, which ensure IP66/IP67 protection rating
- for contact crimping instructions, please see the crimping tool section (10A contacts, CDF and CDM series) on pages 466, 470, 480, 482, 484, 486
- for maximum current load, see the following load curves inserts, for more information see page 494

dimensions in mm

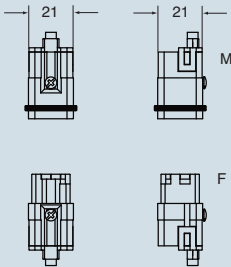

contacts side (front view)



dimensions in mm

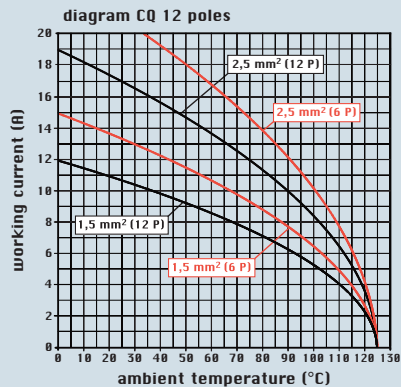
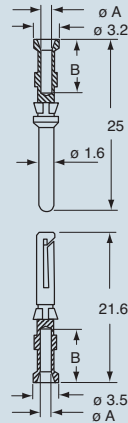

the CR Q12 coding pins (to be ordered separately), allow the user to create 16 different combinations, according to the diagram shown on page 431



CDF and CDM contacts

conductor section mm ²	conductor slot ø A (mm)	conductors stripping length B (mm)
0.14-0.37	0.9	8
0.5	1.1	8
0.75	1.3	8
1.0	1.45	8
1.5	1.8	8
2.5	2.2	6

dimensions shown are not binding and may be changed without notice

enclosures:
 size "21.21" page:
 insulating type 201 - 202
 metallic type 203 - 205
 aggressive environments 325
 EMC 343
 IP68 372 - 373

- inserts and enclosures for applications with temperatures up to 180 °C, available on request
- can also be used partially fitted with 4 mm² section contacts
- for contact crimping instructions, please see the crimping tool section (16A contacts, CCF, CCM and CC...AN series) on pages 466, 470, 480, 482, 484, 486

inserts, crimp connections



16A crimp contacts normal and for advanced opening silver and gold plated



description	part No.	part No.	part No.
without contacts (to be ordered separately) female inserts for female contacts male inserts for male contacts	CQF 05 CQM 05		
16A female contacts 0.14-0.37 mm ² AWG 26-22 three grooves 0.5 mm ² AWG 20 with no grooves 0.75 mm ² AWG 18 one groove (back side) 1 mm ² AWG 18 one groove 1.5 mm ² AWG 16 two grooves 2.5 mm ² AWG 14 three grooves 3 mm ² AWG 12 one wide groove 4 mm ² AWG 12 with no grooves 16A male contacts 0.14-0.37 mm ² AWG 26-22 three grooves 0.5 mm ² AWG 20 with no grooves 0.75 mm ² AWG 18 one groove (back side) 1 mm ² AWG 18 one groove 1.5 mm ² AWG 16 two grooves 2.5 mm ² AWG 14 three grooves 3 mm ² AWG 12 one wide groove 4 mm ² AWG 12 with no grooves 16A male crimp contacts for advanced opening 0.5 mm ² AWG 20 with no grooves 0.75 mm ² AWG 18 one groove (back side) 1 mm ² AWG 18 one groove 1.5 mm ² AWG 16 two grooves 2.5 mm ² AWG 14 three grooves		CCFA 0.3 CCFA 0.5 CCFA 0.7 CCFA 1.0 CCFA 1.5 CCFA 2.5 CCFA 3.0 CCFA 4.0 CCMA 0.3 CCMA 0.5 CCMA 0.7 CCMA 1.0 CCMA 1.5 CCMA 2.5 CCMA 3.0 CCMA 4.0	CCFD 0.3 CCFD 0.5 CCFD 0.7 CCFD 1.0 CCFD 1.5 CCFD 2.5 CCFD 3.0 CCFD 4.0 CCMD 0.3 CCMD 0.5 CCMD 0.7 CCMD 1.0 CCMD 1.5 CCMD 2.5 CCMD 3.0 CCMD 4.0
		silver plated	gold plated
		CC 0.5 AN CC 0.7 AN CC 1.0 AN CC 1.5 AN CC 2.5 AN	

- characteristics according to EN 61984:
16A 230/400V 4kV 3
16A 320/500V 4kV 2
- UL, CSA, CCC, GL, GOST certified
- rated voltage according to UL/CSA: 600V
- insulation resistance: ≥ 10 GΩ
- ambient temperature limit: -40 °C ... +125 °C
- are made of self-extinguishing thermoplastic resin UL 94 V0
- mechanical life: ≥ 500 cycles
- contact resistance: ≤ 1 mΩ
- for maximum current load, see the following load curves inserts, for more information see page 494

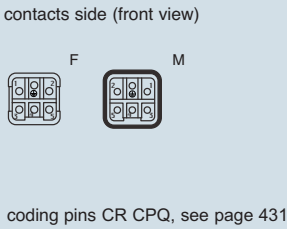
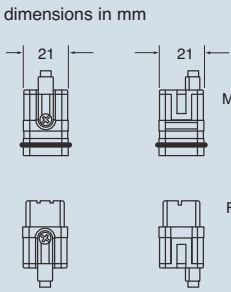
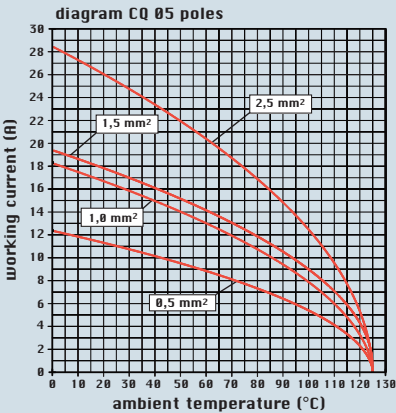

dimensions in mm

CCF and CCM		CC...AN	
25	22.8	22.8	22.8
7.5	7.5	7.5	7.5
2.5	2.5	2.5	2.5
22.2	22.2	22.2	22.2
7.5	7.5	7.5	7.5
4.5	4.5	4.5	4.5
2.5	2.5	2.5	2.5

CCF, CCM and CC...AN contacts			
conductor section	conductor slot	conductors stripping length	
mm ²	ø A (mm)	(mm)	
0.14-0.37	0.9	7.5	
0.5	1.1	7.5	
0.75	1.3	7.5	
1.0	1.45	7.5	
1.5	1.8	7.5	
2.5	2.2	7.5	
3	2.55	7.5	
4	2.85	7.5	

dimensions shown are not binding and may be changed without notice

CQ

ENCLOSURE CHARACTERISTICS



Series	Locking device	Variant	IP (EN 60529) ²⁾	UL 50 Type (NEMA 250 Type)	Environmental temperature range	from page
CK/MK	single		IP44	12	-40 °C ÷ +125 °C	201
		with CKR 65 (D)	IP66/IP67, IP69K ³⁾	12, 4, 4X	-40 °C ÷ +125 °C	
CKA/MKA CKAX/MKAX	single		IP44	12	-40 °C ÷ +125 °C	203
		with CKR 65 (D)	IP66/IP67, IP69K ³⁾	12, 4, 4X	-40 °C ÷ +125 °C	
CKG/MKG CKAG/MKAG	single	for CXL, CJ K and CX 1/2 BD inserts	IP66/IP67, IP69K ³⁾	12, 4, 4X	-40 °C ÷ +125 °C	459
CGK/MGK	screw		IP68, IP69K ³⁾		-40 °C ÷ +125 °C	372
CQ	single	with conductive gasket	IP66/IP67, IP69K ³⁾		-40 °C ÷ +125 °C	206
CZ/MZ	single		IP66, IP69K ³⁾	12, 4, 4X	-40 °C ÷ +125 °C	208
	dual					
CH, CA/MH,	single		IP66, IP69K ³⁾	12, 4, 4X ⁴⁾	-40 °C ÷ +125 °C (R -40 °C ÷ 180 °C)	215
	dual					
T-TYPE	single		IP65	12	-40 °C ÷ +90 °C	282
	dual					
V-Type IP67	single (44.27)		IP67, IP69K ³⁾	12, 4, 4X ⁴⁾	-40 °C ÷ +125 °C	254
	dual (57.27, 77.27 104.27)					
V-Type IP66	single		IP66, IP69K ³⁾	12, 4, 4X ⁴⁾	-40 °C ÷ +125 °C	262
JEI	single		IP66		-40 °C ÷ +125 °C	288
	dual					
BIG enclosures	single (44.27)		IP66		-40 °C ÷ +125 °C	304
	dual (57.77, 77.27 104.27)					
CG/MG	screw or bayonet		IP66, IP68, IP69K ³⁾	12, 4, 4X	-40 °C ÷ +125 °C	372
Central Lever	single central lever		IP65		-40 °C ÷ +125 °C	360
COB	dual		IP20		-40 °C ÷ +125 °C	410

²⁾ the enclosures ensure IP protection rating when coupled and locked with the locking lever. The cover (CS, CP) only provides mechanical protection without ensuring the protection rating

standards

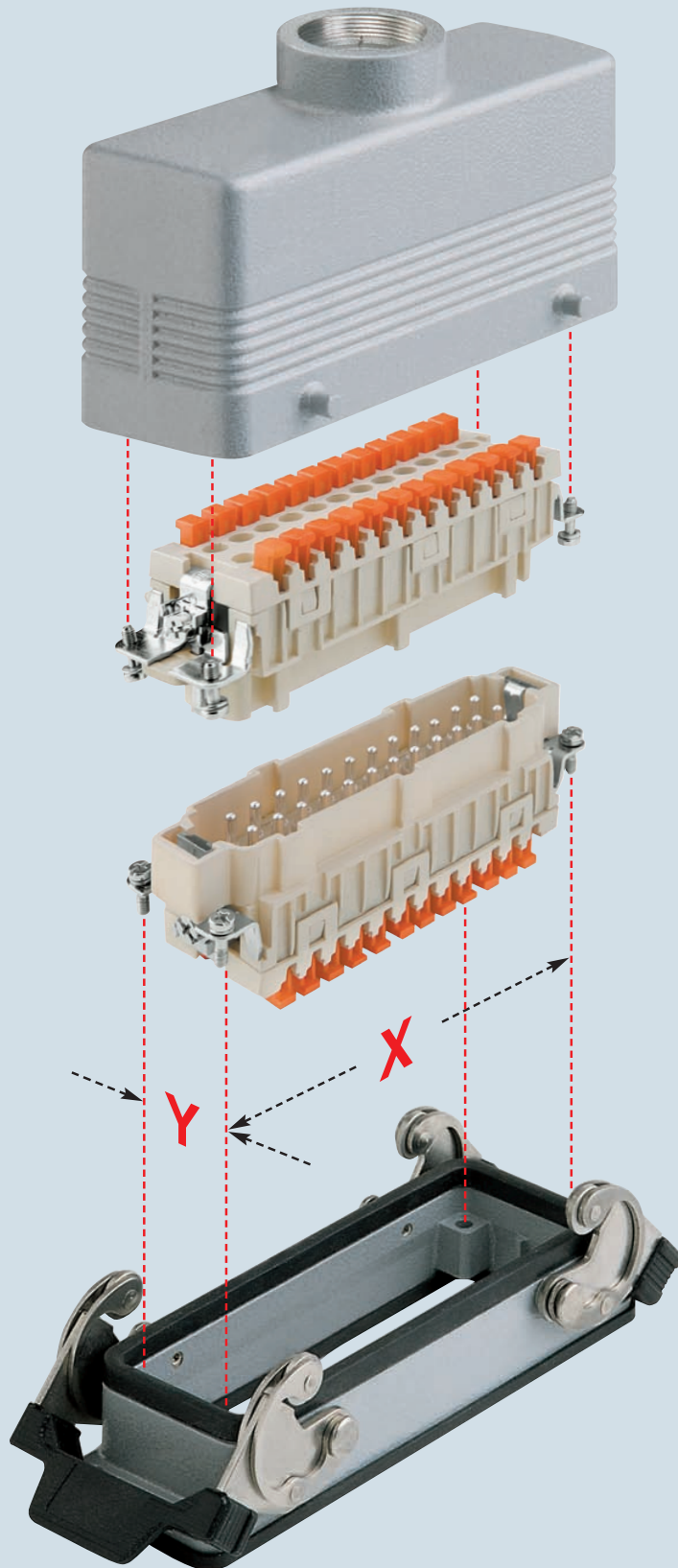

Identification of enclosures

Connector inserts and their enclosures are numerous and therefore the search for the correct pairing of one with another can be complex.

To facilitate this operation (in addition to the normal part number) the definition of “size” has been introduced in this catalogue.

As indicated in the illustration on the left and in the table below the size value refers to the screw fixing centre distances which constitute a unique element since they are common to both the inserts and the enclosures.

All the pages that illustrate combinable articles (inserts and enclosures) carry references as per the examples illustrated on the opposite page.

Following is a table that shows all the sizes of the enclosures and the dimensions of the housings where the inserts will be fastened.

enclosures size	insert housing with screw fixing centre distance x-y
“21.21”	(21 x 21 mm) **
“32.13”	32 x 13 mm
“49.16”	49.5 x 16 mm
“66.16”	66 x 16 mm
“66.40”	66 x 16 mm (2 inserts)
“44.27”	44 x 27 mm
“57.27”	57 x 27 mm
“77.27”	77.5 x 27 mm
“104.27”	104 x 27 mm
“77.62”	77.5 x 27 mm (2 inserts)
“104.62”	104 x 27 mm (2 inserts)

** dimensions relating to the insert cross-section size not being able to identify a screw fixing centre distance since provided with a single screw.

inserts:		page
CK	3 poles + ⊕	40
CK	4 poles + ⊕	40
CKS	3 poles + ⊕	41
CKS	4 poles + ⊕	41
CD	7 poles + ⊕	45
CD	8 poles	46
CQ	5 poles + ⊕	69
CQ	12 poles + ⊕	68

insert dimensions:
21 x 21 mm

bulkhead mounting housings



angled bulkhead mounting housings



description	part no.	part no. (entry - Pg 11)	part no. (entry - M 20)
with lever	CK 03 I (white)		
with lever	CK 03 IN (black)		
without cable gland entry, with lever		CK 03 IA (white)	
without cable gland entry, with lever		CK 03 IAN (black)	
with cable gland entry and lever		CK 03 IAPS (white)	MK IAP20 (white)
with cable gland entry and lever		CK 03 IAPNS (black)	MK IAPN20 (black)
gasket and screw kit for IP66/IP67 ¹⁾ for CK, CQ 05, CKS inserts	CKR 65	CKR 65	
gasket and screw kit for IP66/IP67 ¹⁾ for CD 07/08 inserts	CKR 65 D	CKR 65 D	

panel cut-out for enclosures, in mm

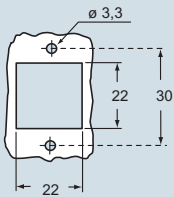

1) To obtain the protection rating IP66/IP67 a kit is provided that includes a gasket to fit under the insert fixing screws supplied with the kit (see illustrative example)
CQ 12 inserts are already supplied with a gasket and screw which ensure IP66/IP67 protection rating

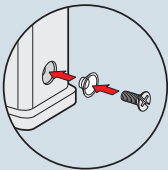

dimensions in mm

CK I(N)

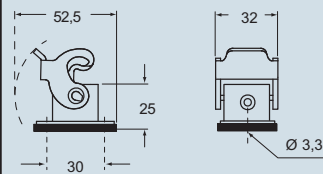

dimensions in mm

CK IA(N)

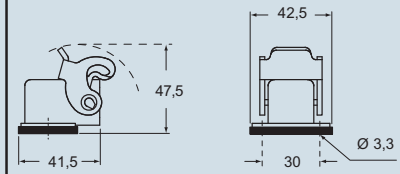

CK IAP(N)S and MK IAP(N)

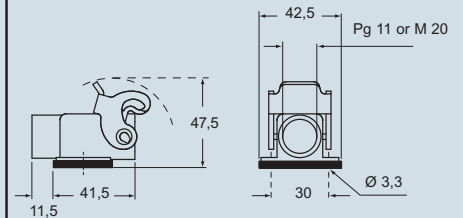

ILME®
Type 12
Type 4/4X only
with CKR 65 (D)



IP66/IP67 with CKR 65 (D) ¹⁾

dimensions shown are not binding
and may be changed without notice



inserts:		page
CK	3 poles + ⊕	40
CK	4 poles + ⊕	40
CKS	3 poles + ⊕	41
CKS	4 poles + ⊕	41
CD	7 poles + ⊕	45
CD	8 poles	46
CQ	5 poles + ⊕	69
CQ	12 poles + ⊕	68

insert dimensions:
21 x 21 mm

hoods



covers



description	part no. (entry - Pg 11)	part no. (entry - M 20)	part no.
with pegs, top entry	CK 03 VS (white)	MK V20 (white)	
with pegs, top entry	CK 03 VNS (black)	MK VN20 (black)	
with pegs, side entry	CK 03 VAS (white)	MK VA20 (white)	
with pegs, side entry	CK 03 VANS (black)	MK VAN20 (black)	
with lever, top entry	CK 03 VGS (white)	MK VG20 (white)	
with lever, top entry	CK 03 VGNS (black)	MK VGN20 (black)	
with pegs and gasket, for female inserts			CK 03 C (white)
with pegs and gasket, for female inserts			CK 03 CN (black)
with pegs, for male inserts			CK 03 CA (white)
with pegs, for male inserts			CK 03 CAN (black)
with lever and gasket, for female inserts			CK 03 CX (white)
with lever and gasket, for female inserts			CK 03 CN (black)
with lever, for male inserts			CK 03 CXA (white)
with lever, for male inserts			CK 03 CXAN (black)
gasket and screw kit for IP66/IP67 ¹⁾ for CK, CQ 05, CKS inserts	CKR 65		
gasket and screw kit for IP66/IP67 ¹⁾ for CD 07/08 inserts	CKR 65 D		

1) To obtain the protection rating IP66/IP67 a kit is provided that includes a gasket to fit under the insert fixing screws supplied with the kit (see illustrative example)
CQ 12 inserts are already supplied with a gasket and screw which ensure IP66/IP67 protection rating

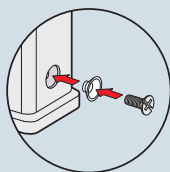

dimensions in mm

CK V(N)S and MK V(N)

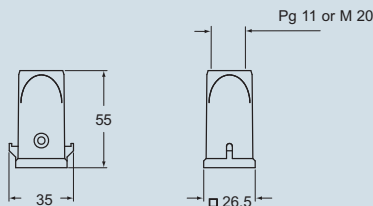

CK VA(N)S and MK VA(N)

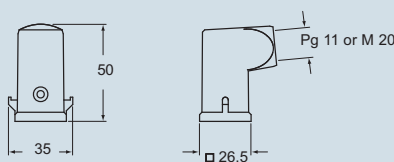

CK VG(N)S and MK VG(N)

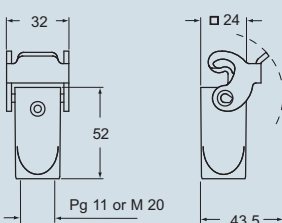

dimensions in mm

CK C(N)

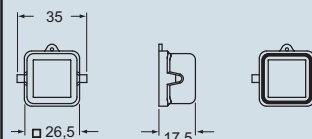

CK CA(N)

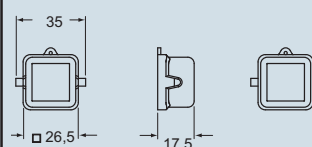

CK CX(N)

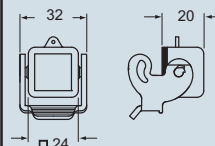

CK CXA(N)

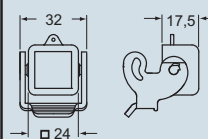

RAUS® Type 12
Type 4/4X only
with CKR 65 (D)



IP66/IP67 with CKR 65 (D) ¹⁾

dimensions shown are not binding
and may be changed without notice

C-TYPE - size 21.21



inserts:		page
CK	3 poles + ⊕	40
CK	4 poles + ⊕	40
CKS	3 poles + ⊕	41
CKS	4 poles + ⊕	41
CD	8 poles	46
CQ	5 poles + ⊕	69
CQ	12 poles + ⊕	68

insert dimensions:
21 x 21 mm

bulkhead mounting housings



angled bulkhead mounting housings



description	part no.	part no. (entry - Pg 11)	part no. (entry - M 20)
with galvanised steel lever with stainless steel lever	CKA 03 I CKAX 03 I		
without cable gland, galvanized steel lever without cable gland, stainless steel lever		CKA 03 IA CKAX 03 IA	
with cable gland, galvanized steel lever with cable gland, stainless steel lever with cable gland, galvanized steel lever, bulkhead hole closed with cable gland, stainless steel lever, bulkhead hole closed		CKA 03 IAPS CKAX 03 IAPS CKA 03 APS CKAX 03 APS	MKA IAP20 MKAX IAP20 MKA AP20 MKAX AP20
gasket and screw kit for IP66/IP67 ¹⁾ for CK, CQ 05, CKS inserts	CKR 65	CKR 65	
gasket and screw kit for IP66/IP67 ¹⁾ for CD 07/08 inserts	CKR 65 D	CKR 65 D	

panel cut-out for enclosures, in mm

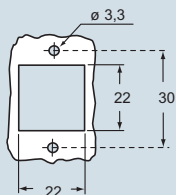

1) To obtain the protection rating IP66/IP67 a kit is provided that includes a gasket to fit under the insert fixing screws supplied with the kit (see illustrative example)
CQ 12 inserts are already supplied with a gasket and screw which ensure IP66/IP67 protection rating

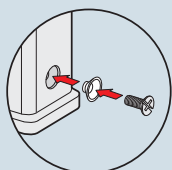

dimensions in mm

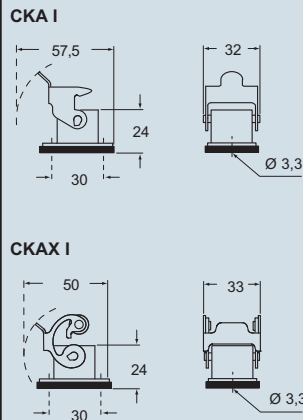

dimensions in mm

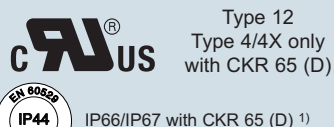
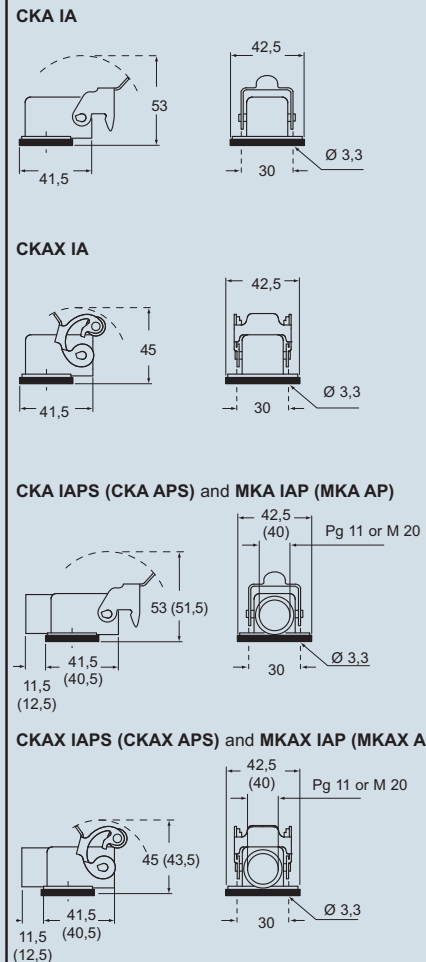

dimensions shown are not binding
and may be changed without notice

C-TYPE - size 21.21

inserts:		page
CK	3 poles + ⊕	40
CK	4 poles + ⊕	40
CKS	3 poles + ⊕	41
CKS	4 poles + ⊕	41
CD	8 poles	46
CQ	5 poles + ⊕	69
CQ	12 poles + ⊕	68

insert dimensions:
21 x 21 mm

angled bulkhead mounting housings

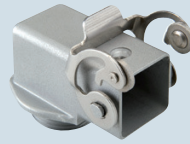

NEW

description	part no.
galvanized steel lever, M20 fixing thread (*)	MKA IAF20 1)
stainless steel lever, M20 fixing thread (*)	MKAX IAF20 1)
galvanized steel lever, M25 fixing thread (*)	MKA IAF25 1)
stainless steel lever, M25 fixing thread (*)	MKAX IAF25 1)
gasket and screw kit for IP66/IP67 1) for CK, CQ 05, CKS inserts	CKR 65
gasket and screw kit for IP66/IP67 1) for CD 07/08 inserts	CKR 65 D

panel cut-out

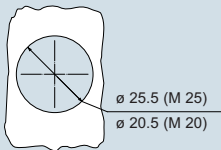

(*) locknut supplied on request, see catalogue cable glands (articles AS M20N and AS M25N metallic, AS M20L and AS M25L insulating)

1) To obtain the protection rating IP66/IP67 a kit is provided that includes a gasket to fit under the insert fixing screws supplied with the kit (see illustrative example)
CQ 12 inserts are already supplied with a gasket and screw which ensure IP66/IP67 protection rating

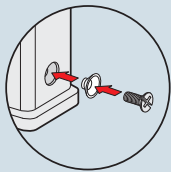

dimensions in mm

MKA IAF

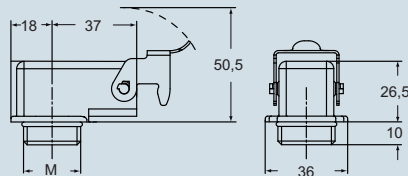

MKAX IAF

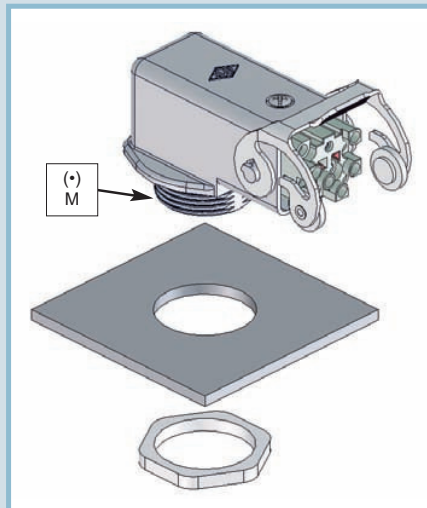
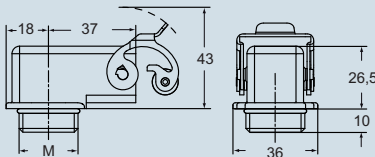

IP66/IP67 with CKR 65 (D) 1)

dimensions shown are not binding and may be changed without notice

C-TYPE - size 21.21



inserts:		page
CK	3 poles + ⊕	40
CK	4 poles + ⊕	40
CKS	3 poles + ⊕	41
CKS	4 poles + ⊕	41
CD	8 poles	46
CQ	5 poles + ⊕	69
CQ	12 poles + ⊕	68

insert dimensions:
21 x 21 mm

hoods



covers

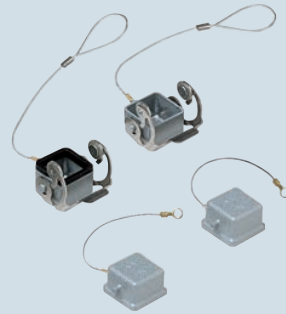

description	part no. (entry - Pg 11)	part no. (entry - M 20)	part no.
with pegs, top entry with pegs, side entry	CKA 03 VS CKA 03 VAS	MKA V20 MKA VA20	
with galvanised steel lever, top entry with stainless steel lever, top entry	CKA 03 VGS CKAX 03 VGS	MKA VG20 MKAX VG20	
with pegs and gasket, for female inserts with pegs, for male inserts			CKA 03 C ¹⁾ CKA 03 CA ¹⁾
with stainless steel lever and gasket, for female inserts with stainless steel lever, for male inserts			CKAX 03 CX CKAX 03 CXA
gasket and screw kit for IP66/IP67 ²⁾ for CK, CQ 05, CKS inserts	CKR 65		
gasket and screw kit for IP66/IP67 ²⁾ for CD 08 inserts	CKR 65 D		

- 1) preferably be used with enclosures CKAX (stainless steel lever).
- 2) To obtain the protection rating IP66/IP67 a kit is provided that includes a gasket to fit under the insert fixing screws supplied with the kit (see illustrative example)
CQ 12 inserts are already supplied with a gasket and screw which ensure IP66/IP67 protection rating

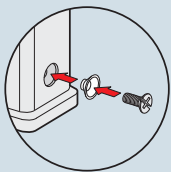

dimensions in mm

CKA VS and MKA V

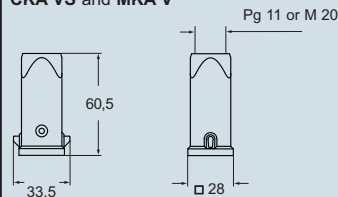

CKA VAS and MKA VA

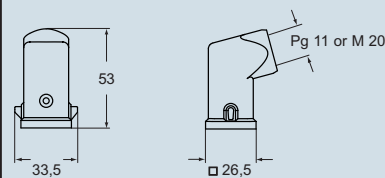

CKA VGS and MKA VG

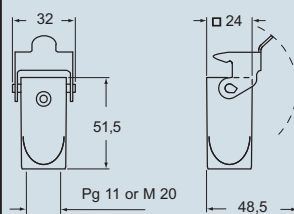

CKAX VGS and MKAX VG

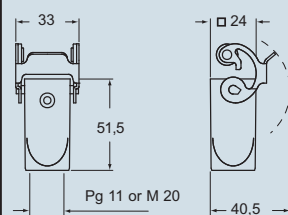

dimensions in mm

CKA C

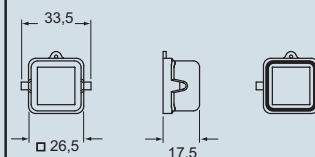

CKA CA

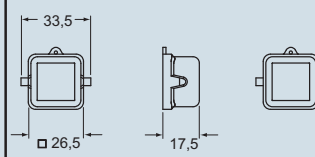

CKAX CX

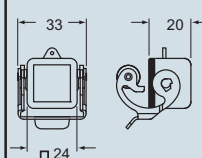

CKAX CXA

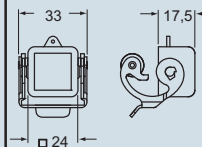

C-TYPE - size 21.21

CAVUS®
Type 12
Type 4/4X only
with CKR 65 (D)



IP66/IP67 with CKR 65 (D) ²⁾

dimensions shown are not binding
and may be changed without notice