

powRgrip®



REGO-FIX®

Made in
Switzerland



Swiss
Precision
Tools



Safe, Precise, Cost-effective

The REGO-FIX powRgrip® is an extremely precise, safe, and cost-effective Press-Fit system, perfect for your high-speed, high-performance cutting applications.

The system delivers superior runout using a toolholder, versatile collet, and a compact benchtop hydraulic clamping unit.

The collet's built in set screw provides precise presetting, repeatable to less than 0.0004" (10µ).

Its slightly tapered shape, combined with the 9-ton tabletop clamping unit, deliver the highest clamping force on the market without dangerous heat or hazardous EMF radiation.

With a simple 10-second clamping cycle and a tool that's ready for immediate use without the need for cool-down, you can complete tool changes in less than 30 seconds

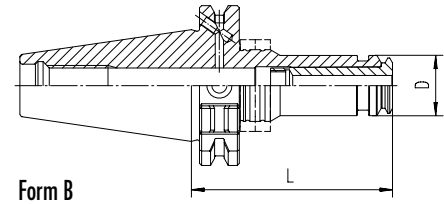
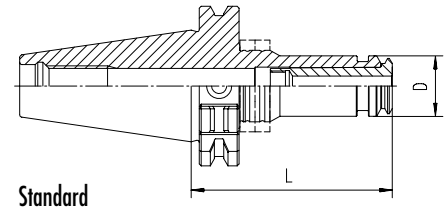

CAT Holders

Type	Standard Part No.	Form B Part No.	D [mm]	L [inch]	Balancing Rings
CAT 40 / PG 10 x 3.5" H	4340.71001	4340.71004	16	3.5	FWR 285
CAT 40 / PG 10 x 6" H	4340.71071	4340.71074	16	6	FWR 285
CAT 40 / PG 15 x 3.15" H	4340.71541	4340.71544	24	3	FWR 285
CAT 40 / PG 15 x 4" H	4340.71551	4340.71554	24	4	FWR 285
CAT 40 / PG 15 x 6" H	4340.71571	4340.71574	24	6	FWR 325/285
CAT 40 / PG 25 x 3.15" H	4340.72541	4340.72544	40	3	FWR 405
CAT 40 / PG 25 x 4" H	4340.72551	4340.72554	40	4	FWR 405
CAT 40 / PG 25 x 6" H	4340.72571	4340.72574	40	6	FWR 405/405
CAT 40 / PG 32 x 4.3" H	4340.73251	4340.73254	50	4.3	FWR 505
CAT 40 / PG 32 x 6" H	4340.73271	4340.73274	50	6	FWR 505/505
CAT 50 / PG 25 x 4" H	4350.72551	4350.72554	40	4.0	FWR 505
CAT 50 / PG 25 x 6" H	4350.72571	4350.72574	40	6.0	FWR 505/405
CAT 50 / PG 32 x 4.3" H	4350.73251	4350.73254	50	4.3	FWR 505
CAT 50 / PG 32 x 6" H	4350.73271	4350.73274	50	6	FWR 505/505

For long reach holders see our line of Xtended Length (XL) Holders.

TC Holders (DIN 69871)

Type	Standard Part No.	Form B Part No.	D [mm]	L [mm]	Balancing Rings
TC 30 / PG 10 x 060*	2230.71020	—	16	60	—
TC 30 / PG 10 x 073 H	4230.71030	—	16	73	FWR 285
TC 30 / PG 15 x 060*	2230.71520	—	24	60	—
TC 30 / PG 15 x 080 H	4230.71540	—	24	80	FWR 285
TC 30 / PG 25 x 080*	2230.72540	—	40	80	—
TC 40 / PG 10 x 080 H	4240.71040	4240.71043	16	80	FWR 285
TC 40 / PG 10 x 120 H	4240.71060	4240.71063	16	120	FWR 285
TC 40 / PG 10 x 160 H	4240.71080	4240.71083	16	160	FWR 325
TC 40 / PG 15 x 072*	2240.71530	2240.71533	24	72	—
TC 40 / PG 15 x 080 H	4240.71540	4240.71543	24	80	FWR 285
TC 40 / PG 15 x 120 H	4240.71560	4240.71563	24	120	FWR 325
TC 40 / PG 15 x 160 H	4240.71580	4240.71583	24	160	FWR 325/285
TC 40 / PG 25 x 072*	2240.72530	2240.72533	40	72	—
TC 40 / PG 25 x 080 H	4240.72540	4240.72543	40	80	FWR 405
TC 40 / PG 25 x 120 H	4240.72560	4240.72563	40	120	FWR 405
TC 40 / PG 25 x 160 H	4240.72580	4240.72583	40	160	FWR 405/405
TC 40 / PG 32 x 080*	2240.73240	2240.73243	50	80	—
TC 50 / PG 25 x 081*	2250.72540	2250.72543	40	81	—
TC 50 / PG 25 x 100 H	4250.72550	4250.72553	40	100	FWR 505
TC 50 / PG 25 x 160 H	4250.72580	4250.72583	40	160	FWR 505/405
TC 50 / PG 32 x 080*	2250.73240	2250.73243	50	80	—

*Not for use with balancing rings.

BT Holders

Type	Standard Part No.	Form B Part No.	D [mm]	L [mm]	Balancing Rings
BT 30 / PG 10 x 062*	2130.71020	—	16	62	—
BT 30 / PG 10 x 080 H	4130.71040	—	16	80	FWR 285
BT 30 / PG 10 x 120 H	4130.71060	—	16	120	FWR 285
BT 30 / PG 10 x 160 H	4130.71080	—	16	160	FWR 285
BT 30 / PG 15 x 070 H	4130.71530	—	24	70	FWR 285
BT 30 / PG 15 x 070 H**	8020.20000	—	24	70	FWR 285
BT 30 / PG 15 x 120 H	4130.71560	—	24	120	FWR 285
BT 30 / PG 25 x 080 H	4130.72540	—	40	80	FWR 405
BT 30 / PG 25 x 080 H**	8020.21000	—	40	80	FWR 405
BT 30 / PG 25 x 160 H	4130.72580	—	40	160	FWR 405/405
BT 40 / PG 10 x 080 H	4140.71040	4140.71043	16	80	FWR 285
BT 40 / PG 10 x 120 H	4140.71060	4140.71063	16	120	FWR 325
BT 40 / PG 10 x 160 H	4140.71080	4140.71083	16	160	FWR 325
BT 40 / PG 15 x 080 H	4140.71540	4140.71543	24	80	FWR 285
BT 40 / PG 15 x 120 H	4140.71560	4140.71563	24	120	FWR 325
BT 40 / PG 15 x 160 H	4140.71580	4140.71583	24	160	FWR 325/285
BT 40 / PG 25 x 080 H	4140.72540	4140.72543	40	80	FWR 405
BT 40 / PG 25 x 120 H	4140.72560	4140.72563	40	120	FWR 405
BT 40 / PG 25 x 160 H	4140.72580	4140.72583	40	160	FWR 405/405
BT 40 / PG 32 x 086*	2140.73240	2140.73243	50	86	—
BT 50 / PG 10 x 120 H	4150.71060	—	16	120	FWR 405
BT 50 / PG 10 x 160 H	4150.71080	—	16	160	FWR 405
BT 50 / PG 15 x 120 H	4150.71560	—	24	120	FWR 325
BT 50 / PG 15 x 160 H	4150.71580	—	24	160	FWR 325
BT 50 / PG 25 x 100*	2150.72550	—	40	100	—
BT 50 / PG 25 x 120 H	4150.72560	—	40	120	FWR 505
BT 50 / PG 25 x 160 H	4150.72580	—	40	160	FWR 505/405
BT 50 / PG 25 x 200 H	4150.72590	—	40	200	FWR 505/405
BT 50 / PG 32 x 100*	2150.73250	—	50	100	—

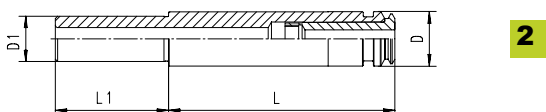
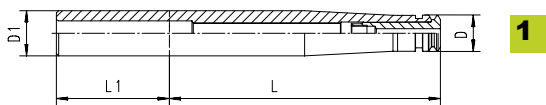

Extensions

Type	Part No.	D [mm]	D1 h6 [mm]	L [mm]	L1 [mm]	Drawing
CYL 10 / PG 10 x 120	2610.71020	15.5	10	120	40	2
CYL 20 / PG 10 x 120	2620.71020	15.5	20	120	50	1
CYL 20 / PG 10 x 160	2620.71040	15.5	20	160	50	1
CYL 20 / PG 10 x 200	2620.71060	15.5	20	200	50	1
CYL 20 / PG 15 x 120	2620.71520	22	20	120	50	2
CYL 25 / PG 25 x 80	8020.25080	40	25	80	50	2
CYL 25 / PG 25 x 100	8020.25100	40	25	100	50	2
CYL 25 / PG 25 x 120	8020.25120	40	25	120	50	2

HSK - Form A

Type	Part No.	D [mm]	L [mm]	Balancing Rings
HSK-A 32 / PG 15 x 075*	2532.71530	22	75	—
HSK-A 40 / PG 15 x 080 H	4540.71540	22	80	FWR 285
HSK-A 40 / PG 25 x 100 H	4540.72550	33	100	FWR 405
HSK-A 50 / PG 10 x 080 H	4550.71040	15.5	80	FWR 285
HSK-A 50 / PG 15 x 080 H	4550.71540	22	80	FWR 285
HSK-A 50 / PG 25 x 100 H	4550.72550	33	100	FWR 405
HSK-A 63 / PG 10 x 080 H	4563.71040	15.5	80	FWR 325
HSK-A 63 / PG 10 x 120 H	4563.71060	15.5	120	FWR 325
HSK-A 63 / PG 10 x 160 H	4563.71080	15.5	160	FWR 325
HSK-A 63 / PG 10 x 200 H	4563.71090	15.5	200	FWR 325
HSK-A 63 / PG 15 x 080 H	4563.71540	22	80	FWR 325
HSK-A 63 / PG 15 x 120 H	4563.71560	22	120	FWR 325
HSK-A 63 / PG 15 x 160 H	4563.71580	22	160	FWR 325/285
HSK-A 63 / PG 25 x 100 H	4563.72550	33	100	FWR 405
HSK-A 63 / PG 25 x 120 H	4563.72560	33	120	FWR 405
HSK-A 63 / PG 25 x 160 H	4563.72580	33	160	FWR 405/405
HSK-A 63 / PG 32 x 100*	2563.73250	43	100	—
HSK-A 63 / PG 32 x 120 H	4563.73260	43	120	FWR 505
HSK-A 80 / PG 15 x 085 H	4580.71540	22	85	FWR 325
HSK-A 80 / PG 25 x 100 H	4580.72550	33	100	FWR 505
HSK-A 80 / PG 32 x 105 H	4580.73250	43	105	FWR 505
HSK-A 100 / PG 10 x 085 H	4500.71040	15.5	85	FWR 405
HSK-A 100 / PG 10 x 160 H	4500.71080	15.5	160	FWR 405
HSK-A 100 / PG 15 x 085 H	4500.71540	22	85	FWR 405
HSK-A 100 / PG 15 x 160 H	4500.71580	22	160	FWR 405/285
HSK-A 100 / PG 25 x 100 H	4500.72550	33	100	FWR 505
HSK-A 100 / PG 25 x 160 H	4500.72580	33	160	FWR 505/405
HSK-A 100 / PG 25 x 200 H	4500.72590	33	200	FWR 505/405
HSK-A 100 / PG 32 x 106 H	4500.73250	43	106	FWR 505

* Not for use with balancing rings

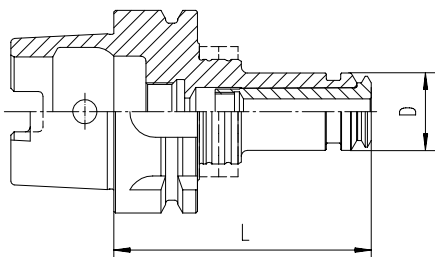

HSK - Form E & F

Type	Part No.	D [mm]	L [mm]	Balancing Rings
HSK-E 25 / PG 10 x 055*	2525.71014	15.5	55	—
HSK-E 32 / PG 10 x 060*	2532.71024	15.5	60	—
HSK-E 32 / PG 10 x 080 H	4532.71044	15.5	80	FWR 225
HSK-E 32 / PG 15 x 075*	2532.71534	22	75	—
HSK-E 40 / PG 10 x 062*	2540.71024	15.5	62	—
HSK-E 40 / PG 10 x 080 H	4540.71044	15.5	80	FWR 225
HSK-E 40 / PG 10 x 120 H	4540.71064	15.5	120	FWR 225
HSK-E 40 / PG 10 x 160 H	4540.71084	15.5	160	FWR 285
HSK-E 40 / PG 15 x 080 H	4540.71544	22	80	FWR 285
HSK-E 40 / PG 15 x 120 H	4540.71564	22	120	FWR 285
HSK-E 40 / PG 25 x 090*	2540.72544	33	90	—
HSK-E 40 / PG 25 x 100 H	4540.72554	33	100	FWR 405
HSK-E 50 / PG 10 x 080 H	4550.71044	15.5	80	FWR 285
HSK-E 50 / PG 10 x 120 H	4550.71064	15.5	120	FWR 285
HSK-E 50 / PG 10 x 160 H	4550.71084	15.5	160	FWR 285
HSK-E 50 / PG 15 x 080 H	4550.71544	22	80	FWR 285
HSK-E 50 / PG 15 x 120 H	4550.71564	22	120	FWR 285
HSK-E 50 / PG 25 x 100 H	4550.72554	33	100	FWR 405
HSK-F 63 / PG 10 x 080 H	4563.71045	15.5	80	FWR 325
HSK-F 63 / PG 15 x 080 H	4563.71545	22	80	FWR 325
HSK-F 63 / PG 25 x 100 H	4563.72555	33	100	FWR 405
HSK-F 63 / PG 32 x 100*	2563.73255	43	100	—
HSK-F 80	Call For Availability			

*Not for use with balancing rings.

CAPTO Holders

Type	Part No.	D [mm]	L [mm]	Balancing Rings
C3 / PG 10 x 055*	2803.71010	16	55	–
C3 / PG 15 x 067*	2803.71520	24	67	–
C4 / PG 10 x 060*	2804.71020	16	60	–
C4 / PG 10 x 080 H	4804.71040	16	80	FWR 225
C4 / PG 15 x 062*	2804.71520	24	62	–
C4 / PG 15 x 080 H	4804.71540	24	80	FWR 285
C5 / PG 10 x 060*	2805.71020	16	60	–
C5 / PG 10 x 080 H	4805.71040	16	80	FWR 285
C5 / PG 10 x 120 H	4805.71060	16	120	FWR 285
C5 / PG 15 x 065*	2805.71520	24	65	–
C5 / PG 15 x 080 H	4805.71540	24	80	FWR 285
C5 / PG 15 x 120 H	4805.71560	24	120	FWR 325
C5 / PG 25 x 080*	2805.72540	40	80	–
C5 / PG 25 x 100 H	4805.72550	40	100	FWR 405
C6 / PG 10 x 080 H	4806.71040	16	80	FWR 325
C6 / PG 10 x 120 H	4806.71060	16	120	FWR 325
C6 / PG 10 x 160 H	4806.71080	16	160	FWR 325
C6 / PG 15 x 080 H	4806.71540	24	80	FWR 325
C6 / PG 15 x 120 H	4806.71560	24	120	FWR 325
C6 / PG 15 x 160 H	4806.71580	24	160	FWR 325
C6 / PG 25 x 085*	2806.72540	40	85	–
C6 / PG 25 x 100 H	4806.72550	40	100	FWR 405
C6 / PG 25 x 120 H	4806.72560	40	120	FWR 405
C6 / PG 25 x 160 H	4806.72580	40	160	FWR 405
C6 / PG 32 x 090*	2806.73240	50	90	–
C8 / PG 25 x 092*	2808.72540	40	92	–
C8 / PG 32 x 090*	2808.73240	50	90	–

*Not for use with balancing rings.

ISO 20

Type	Part No.	D [mm]	L [mm]
ISO 20 / PG 10 x 058*	2420.71015	16	48

* Supplied with integral Pull Stud - for use with powRgrip tool holding system

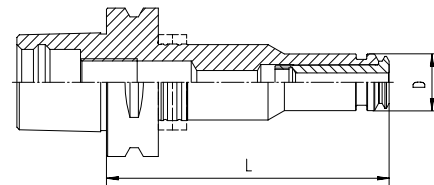

Balancing Rings

Type	Part No.	d mm	D mm	L mm	Balancing capacity [gmm]
Set FWR 225	7490.22500	22.5	30.5	6.0	32.00
Set FWR 285	7490.28500	28.5	36.5	6.0	44.00
Set FWR 325	7490.32500	32.5	40.5	6.0	56.00
Set FWR 405	7490.40500	40.5	48.5	6.0	80.00
Set FWR 505	7490.50500	50.5	60.5	7.0	170.00

Supplied: 1 Set with 2 Hi-Q Balancing Rings

TSD 0.9 Nm	7159.09000	Torque screwdriver TORX 8 for balancing rings
------------	------------	---



powRgrip® Collets

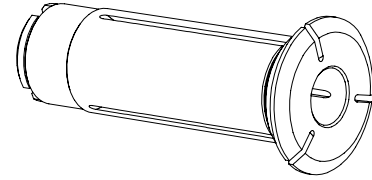

powRgrip® PG 10 Collets

Dia. (mm)	Dia. (inch)	PG 10 Part No.	PG 10CF Part No.
2.000		1710.02000	
2.500		1710.02500	
3.000		1710.03000	1710.03002
3.500		1710.03500	--
3.175	1/8"	1710.03181	1710.03183
4.000		1710.04000	1710.04002
4.500		1710.04500	--
4.763	3/16"	1710.04761	1710.04763
5.000		1710.05000	1710.05002
5.500		1710.05500	--
6.000		1710.06000	1710.06002
6.350	1/4"	1710.06351	1710.06353

powRgrip® PG 15 Collets

Dia. (mm)	Dia. (inch)	PG 15 Part No.	PG 15CF Part No.
3.000		1715.03000	1715.03002
3.175	1/8"	1715.03181	1715.03183
3.500		1715.03500	--
4.000		1715.04000	1715.04002
4.500		1715.04500	--
4.763	3/16"	1715.04761	1715.04763
5.000		1715.05000	1715.05002
5.500		1715.05500	--
6.000		1715.06000	1715.06002
6.350	1/4"	1715.06351	1715.06353
7.000		1715.07000	1715.07002
7.938	5/16"	1715.07941	1715.07943
8.000		1715.08000	1715.08002
9.000		1715.09000	1715.09002
9.525	3/8"	1715.09521	1715.09523
10.000		1715.10000	1715.10002

powRgrip® PG 25 & PG 32 Collets

Dia. (mm)	Dia. (inch)	PG 25 Part No.	PG 25CF Part No.	PG 32 Part No.	PG 32CF Part No.
3.000		1725.03000	1725.03002		
3.175	1/8"	1725.03181	1725.03183		
3.500		1725.03500	--		
4.000		1725.04000	1725.04002		
4.500		1725.04500	--		
4.763	3/16"	1725.04761	1725.04763		
5.000		1725.05000	1725.05002		
5.500		1725.05500	--		
6.000		1725.06000	1725.06002	1732.06000	1732.06002
6.350	1/4"	1725.06351	1725.06353	1732.06351	1732.06353
7.000		1725.07000	1725.07002	1732.07000	1732.07002
7.938	5/16"	1725.07941	1725.07943	1732.07941	1732.07943
8.000		1725.08000	1725.08002	1732.08000	1732.08002
9.000		1725.09000	1725.09002	1732.09000	1732.09002
9.525	3/8"	1725.09521	1725.09523	1732.09521	1732.09523
10.000		1725.10000	1725.10002	1732.10000	1732.10002
11.000		1725.11000	1725.11002	1732.11000	1732.11002
11.113	7/16"	1725.11111	1725.11113	1732.11111	1732.11113
12.000		1725.12000	1725.12002	1732.12000	1732.12002
12.700	1/2"	1725.12701	1725.12703	1732.12701	1732.12703
14.000		1725.14000	1725.14002	1732.14000	1732.14002
14.288	9/16"	1725.14291	1725.14293	1732.14291	1732.14293
15.875	5/8"	1725.15881	1725.15883	1732.15881	1732.15883
16.000		1725.16000	1725.16002	1732.16000	1732.16002
17.463	11/16"	1175.17461			
18.000		1725.18000	1725.18002	1732.18000	1732.18002
19.050	3/4"	1725.19051	1725.19053	1732.19051	1732.19053
20.000		1725.20000	1725.20002	1732.20000	1732.20002
22.000				1732.22000	1732.22002
22.225	7/8"			1732.22231	1732.22233
25.000				1732.25000	1732.25002
25.400	1"			1732.25401	1732.25403

PG Collets do not have a clamping range.
Nominal diameter only. Requires h6 tolerance shanks

powRgrip® Micro-bore Collets

Dia (mm)	Dia (inch)	PG 10
0.200		1710.00209
0.300		1710.00309
0.400		1710.00409
0.500		1710.00509
0.600		1710.00609
0.700		1710.00709

Dia (mm)	Dia (inch)	PG 10
0.800		1710.00809
0.900		1710.00909
1.000		1710.01009
1.500		1710.01509
1.588	1/16"	1710.01589



Automatic Machine

Type	Part #	Description
PGU 9000 A	7610.90100	110 V machine
APG 910	7611.10900	PG 10 clamping insert
APG 915	7611.15900	PG 15 clamping insert
APG 925	7611.25900	PG 25 clamping insert
APG 932	7611.32900	PG 32 clamping insert

Compact Machine

Type	Part #	Description
Single PG Series Complete Compact Sets (Fixed dies non-interchangeable)		
PG 10 Set	7620.10901	PG 10 Complete Compact Set*
PG 15 Set	7620.15901	PG 15 Complete Compact Set*
PG 25 Set	7620.25901	PG 25 Complete Compact Set*
Compact Set with Interchangeable Inserts for the different PG series		
PGC 2510	7621.25109	powRgrip® Compact hydraulic clamping unit
APC 25	7622.25000	Insert for PGC 2510 for PG 25 toolholders
APC 15	7622.15000	Insert for PGC 2510 for PG 15 toolholders
APC 10	7622.10000	Insert for PGC 2510 for PG 10 toolholders

Preset Adapters

Type	Part #	Description
VEW 10	7619.10000	PG 10 Presetter
VEW 15	7619.15000	PG 15 Presetter
VEW 25	7619.25000	PG 25 Presetter
VEW 32	7619.32000	PG 32 Presetter



powRgrip - Features & Benefits



Clamping operation in less than 10 seconds when using the PGU automatic machine.



Clamps all types of toolshanks and materials in h6 tolerance from Ø 0.0079" – 1.0" (0.2 – 25.4 mm)

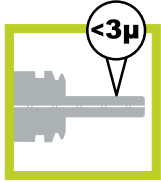

T.I.R. of $< 0.0001''$ ($3 \mu\text{m}$)

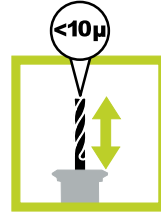

Precise length adjustment repeatability $< 0.0004''$ ($10 \mu\text{m}$)



High vibration dampening due to the interrupted surfaces between the toolholder to collet and the collet to tool shank.



Developed for optimal productivity such as High Speed Cutting (HSC) and High Performance Cutting (HPC)



Highest transferable torque and lowest T.I.R., even after 20,000 tool changes



For 5 years or 20,000 cycles, REGO-FIX guarantees the T.I.R. of the powRgrip holder and collet will not exceed 0.0001" and that the impregnated surface treatment will not erode.

Transferable Torque of the powRgrip System

